

Antrobus Parish Council - Fixed Assets Register 22-03B for end yr

Cover 1 Jun - 31 May

inflation /yr:-

1.03

=>total inflation

21/22 Additions in red

base year

2007

over x yrs:

this year

2022

1.513

x years inflation

15

Asset	Purchase cost or proxy. Total = box 9 of Annual Return	Base-line Yr.	Baseline replacement value on baseline year (see left col.)	No years inflation (This Yr. - Base-line Yr.)	Jun 2022 replacement cost (2007 baseline + x years inflation). (totals = guide for ins category cover)
Street furniture			£11,210.86		£17,466
Bus Shelter	£3,693	2007	£5,053	15	£7,872.81
Seats					
Bench - Village centre	£700	2007	£700	15	£1,090.58
Bench - Church	£500	2007	£500	15	£778.98
Knutsford Rd/Nr Pole Lane	£660	2007	£660	15	£1,028.26
Flag Pole & 2 flags	£505	2007	£505	15	£787.26
Notice Board - Village	£758	2007	£758	15	£1,180.91
Notice Board - Gibb Hill	£379	2007	£379	15	£590.44
Notice Board - Frandley	£379	2007	£379	15	£590.44
Finger Posts	£0	2007	£0	15	£0.00
Boundary Signs:					
Knutsford Road	£457.29	2007	£457.29	15	£712.44
A559	£457.29	2007	£457.29	15	£712.44
Belmont A559	£457.29	2007	£457.29	15	£712.44
Comberbach	£180.64	2007	£180.64	15	£281.43
Arley Straight	£180.64	2007	£180.64	15	£281.43
Lake Lane	£271.60	2007	£271.60	15	£423.14
Hall Lane	£271.60	2007	£271.60	15	£423.14
Outside equipment incl Garden			£601		£935
Chain of Office	£600.00	2007	£600.00	15	£934.78
100 Year Stone + Tree	£0.00	2007	No insurance value		
Defibrillator and wall cupboard	£1.00	??	£1.00		
Tommy Silhouette near flag pole	£210.00		£210.00	0	£210.00
Barrels & planting near flag pole	£243.00		£243.00	0	£243.00
Equipment Hub Shed (Flood emergency)	£395.00		£395.00	0	£395.00
Mower & Machinery			£0.00		£0.00
Lawnmower	transferred		£0.00		£0.00
General / Office contents			£2,165		£2,824
Chairman's Board	£600	2007	£600	15	£934.78
MacBook and Printer	£1,105	2020	£1,105	2	£1,172.29
4-drawer filing cabinet	£200.00	2007	£200.00	15	£311.59
4-drawer filing cabinet	£200.00	2007	£200.00	15	£311.59
2-drawer Filing cabinet	£60.00	2007	£60	15	£93.48
Playground Equipment:			£29,033		£41,773
Nest / Basket Swing	£3,370.00	2017	£3,370.00	5	£3,906.75
Multiplay / Activity Tower	£12,222.00	2007	£12,222.00	15	£19,041.48
Junior Swings 2 seat	£3,897.00	2020	£3,897.00	2	£4,134.33
ddler / Cradle Swings 2 seat	£2,020.20	2007	£2,020.20	15	£3,147.41
Carousel / Roundabout	£5,966.10	2007	£5,966.10	15	£9,294.99
Springy Rocker / Horse	£473.55	2007	£473.55	15	£737.78
Playground Bench x 2	£724.50	2007	£724.50	15	£1,128.75
Playground Litter Bin	£360.00	2020	£360.00	2	£381.92
Other surfaces			£11,419		£17,776
Playground Soft Surfacing	£10,910.94	2007	£10,680.94	15	£16,640.56
Animal Grid	£668.27	2007	£668.27	15	£1,041.14
Litter pick equipment	£70.00	2012	£70.00	10	£94.07
Lease for Jubilee Playground					
Lease for Jubilee Greener Antrobus Community allotment based 31 Aug 2018					
Gates and Fences			£7,413		£10,778

Playground Fencing & Gates I	£5,293.28	2007	£5,293.28	15	£8,246.76
Playground Fencing & Gates II	£2,120.00	2016	£2,120.00	6	£2,531.39
War Memorials	£0.00				
Natural surfaces	£0.00				
Sports equipment	£0.00				
TOTAL	£61,561		£61,843		£91,552

This plan to be updated (2018-04)

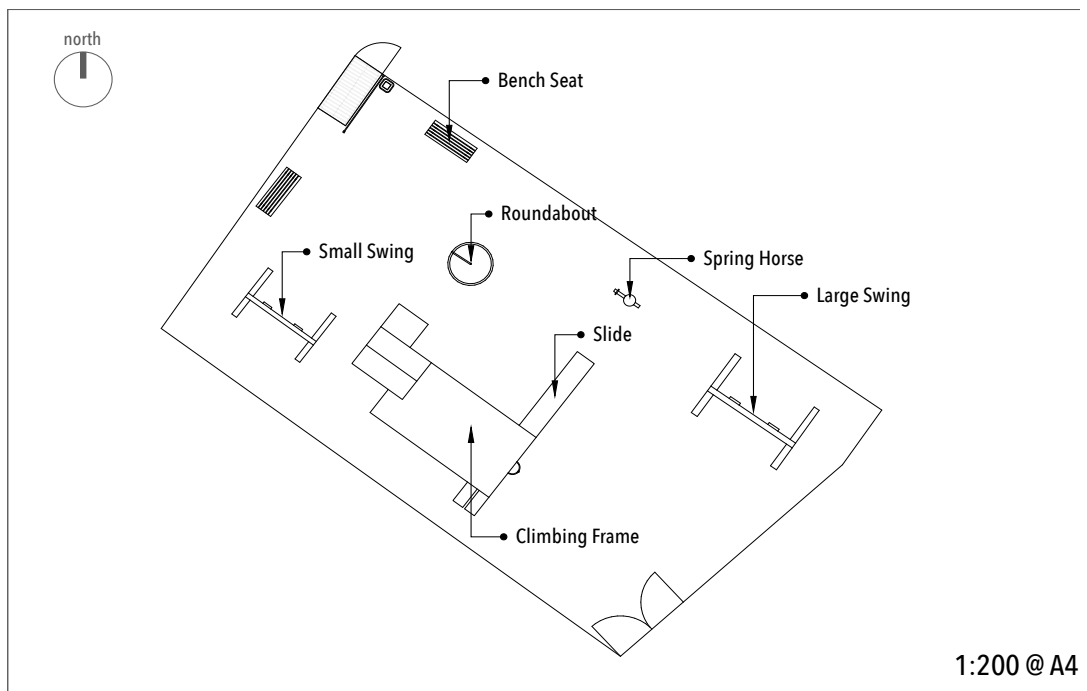

© Crown Copyright 2015. All rights reserved. Licence Number 100047514



Playground Detail | Not to be used in any contract document

June 8, 2016

Antrobus Village Hall | Land



LEGEND:

-  Existing Lease
-  Additional Land
- New lease incorporating both areas

Explanation Plan | Not to be used in any contract document

Notes (Apr 2016)

1/ When the fixed assets is reviewed it regularly causes confusion and I think it's because we all want the as think it helps not to give the asset value any meaning and treat it only a necessary number to fulfil the requir

The External Auditors notes 2010/11 summarised the requirements as follows (which changed in 10/11) :-

- If purchase cost known, record the purchase cost and remain unchanged until disposal.
- If not known, establish a current value for the asset in 2011 and remain unchanged until disposal. This
- Where an asset has been gifted to the body, so that no cost has been incurred, use the current value c
- Where an asset is a community asset, i.e. it has no market value due to its legal status (e.g. war men

Once I have a value by individual asset, if in the future any asset is disposed of, I now know the figure to sub purchased, then I would use the purchase figure to up the total asset value).

In Apr 2016 the existing intermittent values totalling only 6,705 (see Apr 2015) were replaced by the insurar that we have been reporting previously in the accounts.

2/ Unfortunately there is a second objective of reviewing the asset register and that pertains to the second c assets. We can then check that the subtotals don't exceed the current insurance values for the relevant 6 cat

When I get the insurance quotations next month I will check what kind of 'replacement' cover is on offer. Exa The point of this note is just to say the wording of the insurance policy is just as critical as the valuation or cost of rep

For example the policy may say 'replacement with like items' to mean that "like" means in functional terms, as against exactly the same make or style, or the policy might be a cash settlement based on cost of replacement or current value. The two are different as you can appreciate.

Different sectors of the insurance market have different approaches in their standard wording for example d The insurance company need to give clear advice on how they treat claims in the context of the wording of tl

The 2007 values are believed to be supplied form the insurance company but since then they have only repo estimated value by item for a replacment cost in current terms (Apr 2016). The subtotal is compared with the should increase.

To be updated before publication

Antrobus Parish Council - Fixed Assets Register

Property categories	Asset	
Street furniture	Bus Shelter	
	<u>Seats</u>	
	Village centre	
	Church	
	Knutsford Rd/Nr Pole Lane	
	Flag Pole & 2 flags	
	Notice Board - Village	
	Notice Board - Gibb Hill	
	Notice Board - Frandley	
	<u>Boundary Signs:</u>	
	Knutsford Road	
	A559	
	Belmont A559	
	Comerbach	
	Arley Straight	
	Lake Lane	
	Hall Lane	
General contents	Chain of Office	
	100 Year Stone + Tree	
Outside equipment	Chairman's Board	
Office Contents	<u>Office equipment</u>	
	Laptop and Printer	
	4-drawer filing cabinet	
	4-drawer filing cabinet	
	Filing cabinet 2-drawer	
Playground Equipment:	<u>Playground Equipment:</u>	
	Activity Tower	
	Junior Swings	
	Cradle Swings	
	Roundabout	
	Springy Rocker	
	Bench x 2	
	Litter Bin	
	Soft Surfacing	
	Fencing & Gates	
	Animal Grid	
	Land	None owned - all rented
		Lease for Jubilee Playground
		Lease for Jubilee Greener Antrobus Community allotment
	Other	Litter pick equipment
Defibrillator and wall cupboard		
TOTAL		